

PKG TYPE
SOP8 (DF)

PKG CODE
FP8

NOTE)
1. DIMENSIONS *1 (Nom) AND *2
DO NOT INCLUDE MOLD FLASH.
2. DIMENSION *3 DOES NOT
INCLUDE TRIM OFFSET.

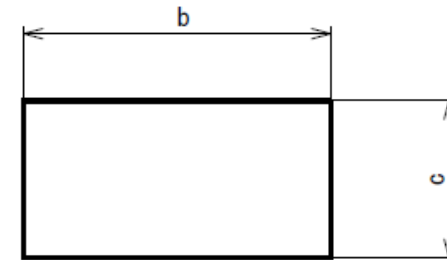
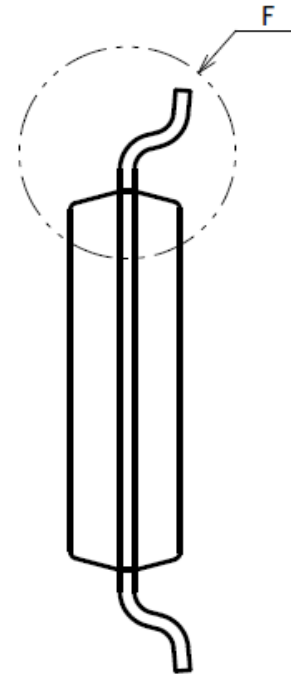
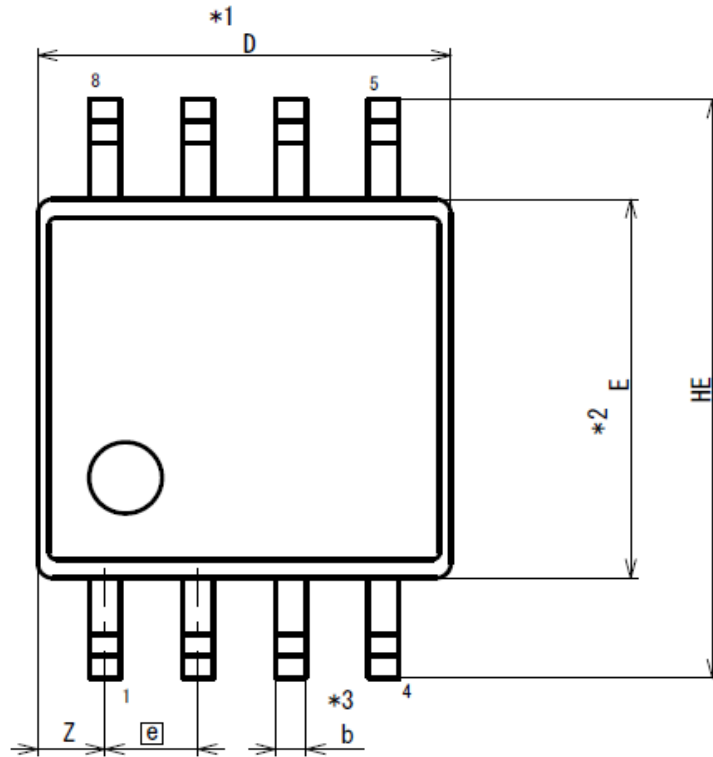

Terminal cross section
(Ni/Pd/Au plating)

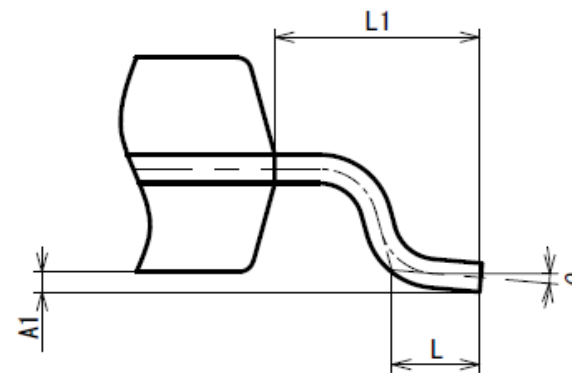

Detail F

Reference Symbol	Dimension in Millimeters		
	Min	Nom	Max
D	5.55	5.65	5.75
E	5.20	—	5.40
A1	0.102	—	0.254
A	1.55	—	1.73
b	0.356	0.42	0.483
c	0.203	0.22	0.254
θ	0°	—	10°
HE	8.00	—	8.20
e	1.02	1.27	1.52
Z	—	—	1.02
L	0.4	0.6	0.8
L1	—	1.4	—